

GUIDE

DE POSE ET DE RÉGLAGE
PORTE INUIT+

GUIDE DE POSE ET DE RÉGLAGE DES PORTES GERVAIS INUIT+

IL EST RECOMMANDÉ DE GARDER L'OUVRANT DANS LE DORMANT

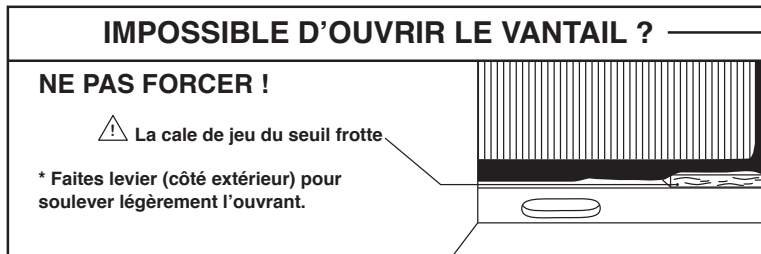
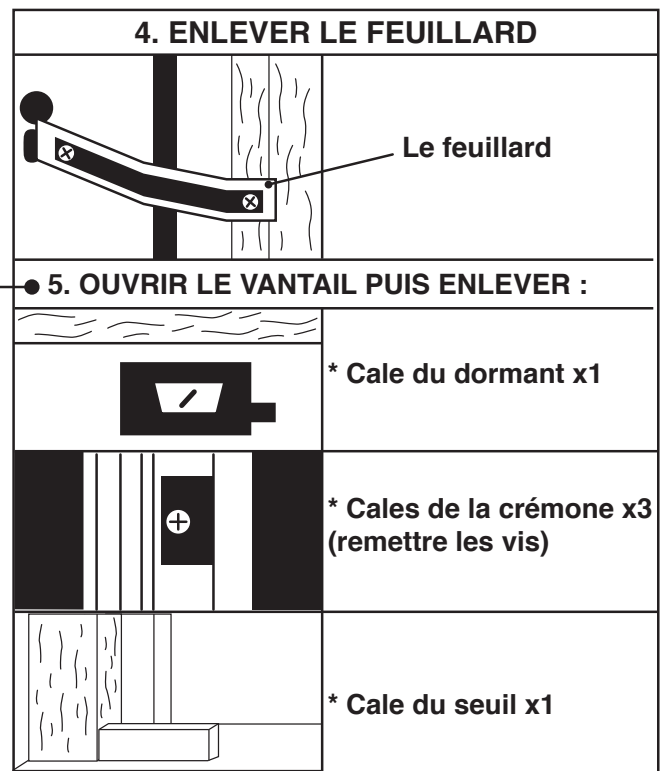
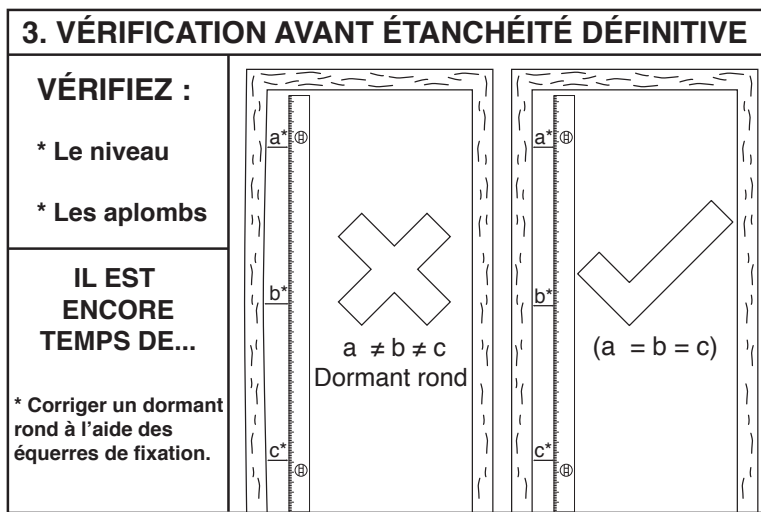
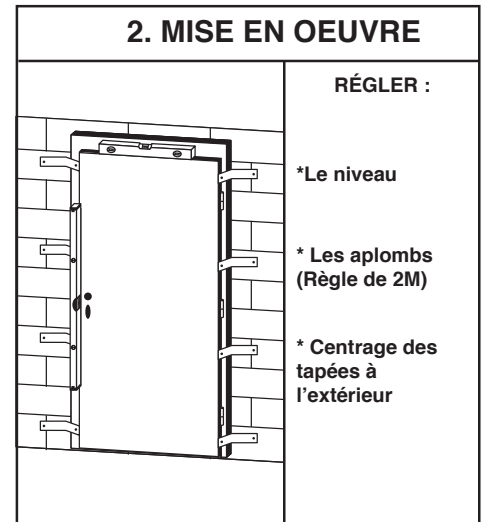
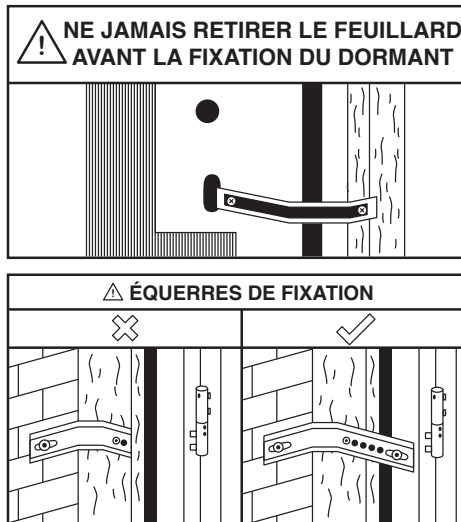

RÉGLAGES : IL EST IMPÉRATIF D'APPLIQUER UN RÉGLAGE IDENTIQUE SUR TOUTES LES FICHES. LES FICHES DOIVENT ÊTRE ALIGNÉES (RÈGLE DE 2M)

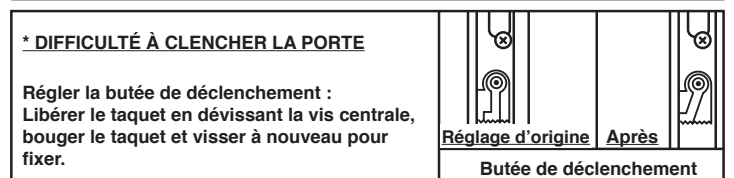
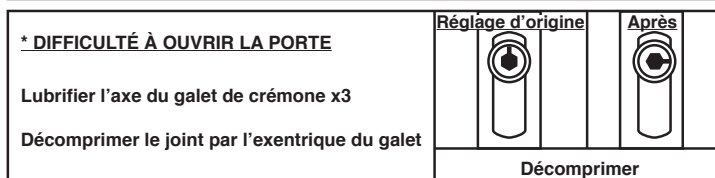
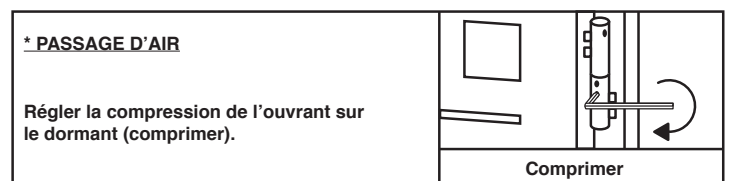
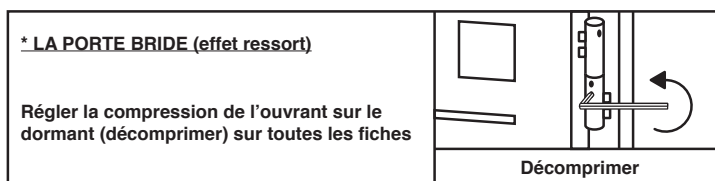
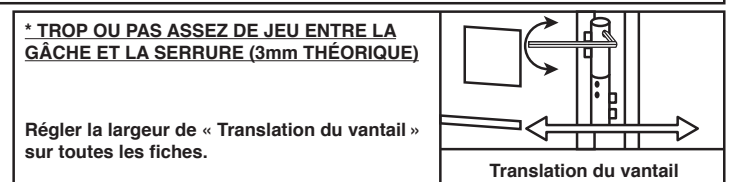
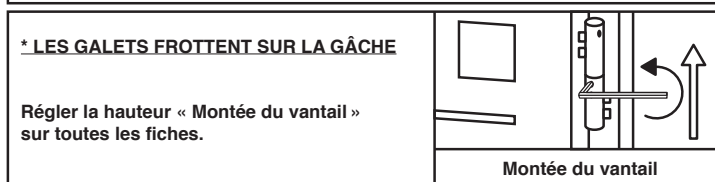

PENSER À LUBRIFIER LES AXES DES ROULEAUX DE CRÉMONE